

Ø 101.6mm  
[4.00in]

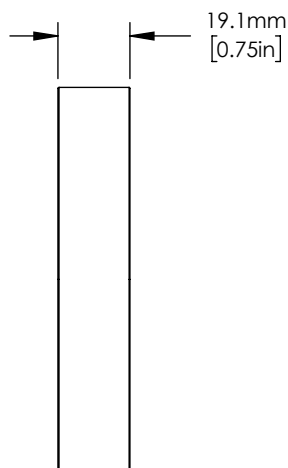

19.1mm  
[0.75in]

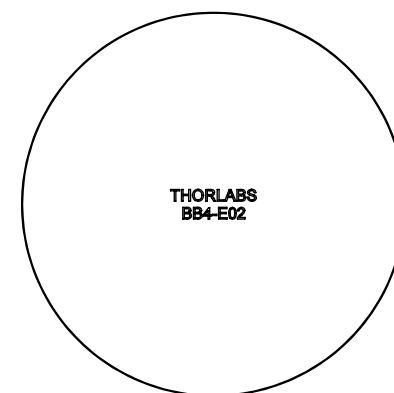

NOTES/SPECIFICATIONS:

1. CLEAR APERTURE: > Ø 86.4 mm
2. SURFACE FLATNESS:  $\lambda/10$  AT 633 nm OVER CLEAR APERTURE
3. SURFACE QUALITY: 10-5 SCRATCH-DIG
4. BACK SURFACE: FINE GROUND
5. PARALLELISM:  $\leq 3$  arcmin
6. THICKNESS TOLERANCE:  $\pm 0.2$  mm
7. DIAMETER TOLERANCE: + 0.0/-0.1 mm
8. DESIGN WAVELENGTH RANGE: 400-750 nm
9. COATING: BROADBAND HR, DIELECTRIC  
 $R_s$  avg: >99% FROM 400-750 nm  
 $R_p$  avg: >99% FROM 400-750 nm  
 AOI: 0° TO 45°
10. DAMAGE THRESHOLD: 0.250 J/cm<sup>2</sup> 10 ns PULSE, 10 Hz AT 532 nm

FOR INFORMATION ONLY  
NOT FOR MANUFACTURING PURPOSES

DRAWING PROJECTION			 www.thorlabs.com	
	NAME	DATE		
DRAWN	BAG	25/OCT/10	Ø 101.6 mm BROADBAND MIRROR 400-750 nm	
APPROVAL	BW	04/NOV/21	MATERIAL	REV
COPYRIGHT © 2021 BY THORLABS			FUSED SILICA	C
VALUES IN PARENTHESIS ARE CALCULATED AND MAY CONTAIN ROUND OFF ERRORS			ITEM #	APPROX WEIGHT
			BB4-E02	0.24 kg