

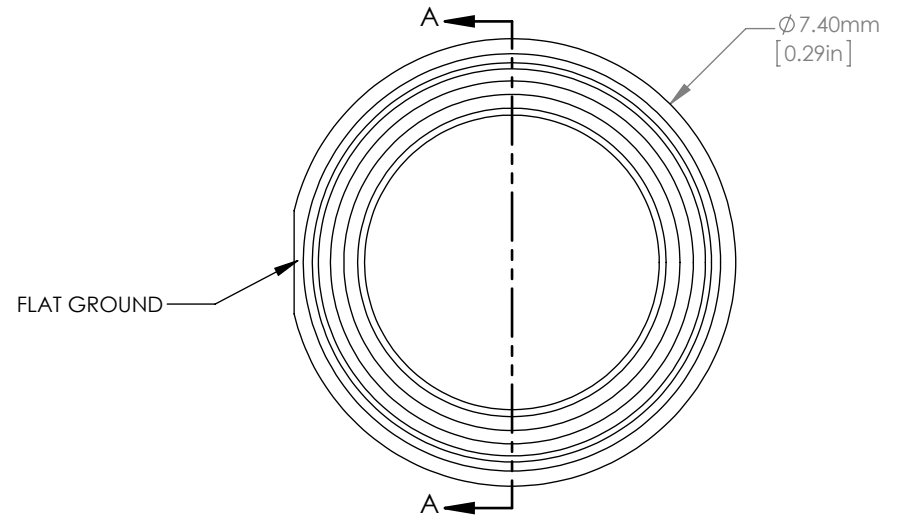

ISOMETRIC VIEW

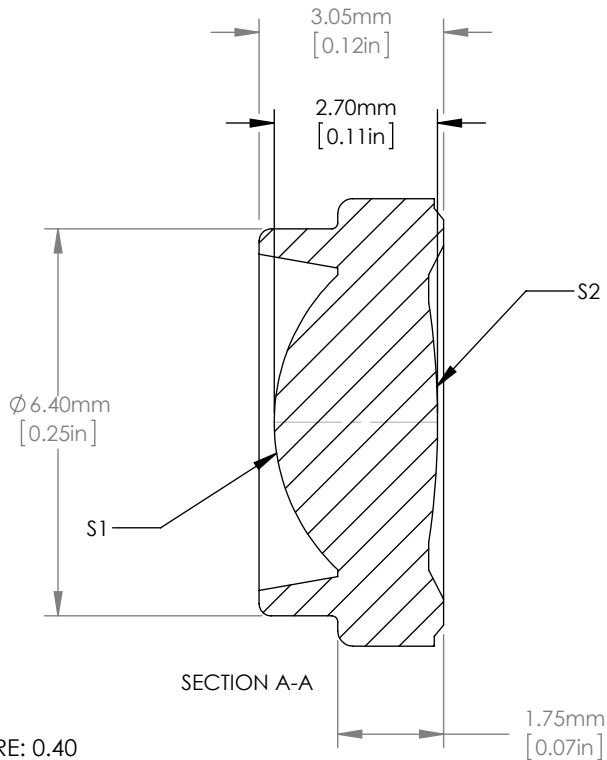

NOTES/SPECIFICATIONS:

1. NUMERICAL APERTURE: 0.40
2. CLEAR APERTURE: 2.70mm
3. SURFACE QUALITY: 80-50 SCRATCH-DIG
4. DESIGN WAVELENGTH: 785nm
5. FREE WORKING DISTANCE: 2.00mm
6. RMS WAVEFRONT ERROR:
 1. ON AXIS: 0.040λ
 2. TOTAL: 0.065λ
7. N-BK7 WINDOW CORRECTION: 0.25mm
8. OPERATING TEMPERATURE: 5-65°C
9. STORAGE TEMPERATURE: -25-70°C
10. COATING (S1 & S2): AR
785, $R_{avg} < 5.0\%$
0° AOI

FOR INFORMATION ONLY
NOT FOR MANUFACTURING PURPOSES

DRAWING PROJECTION			THORLABS www.thorlabs.com	
NAME	DATE	MOLDED PLASTIC ASPHERIC LENS f = 3.32mm ϕ 7.4mm		
DRAWN	GG	17/JUL/13	MATERIAL	REV
APPROVAL	DD	17/JUL/13	ACRYLIC	D
COPYRIGHT © 2013 BY THORLABS			ITEM #	APPROX WEIGHT
VALUES IN PARENTHESIS ARE CALCULATED AND MAY CONTAIN ROUND OFF ERRORS			CAY033	20 g