

	PART	MATERIAL
①	MECHANICAL HOUSING	BLACK ANODIZED ALUMINUM
②	MRA25-P01	N-BK7

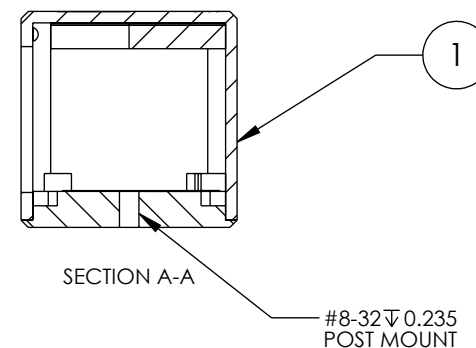
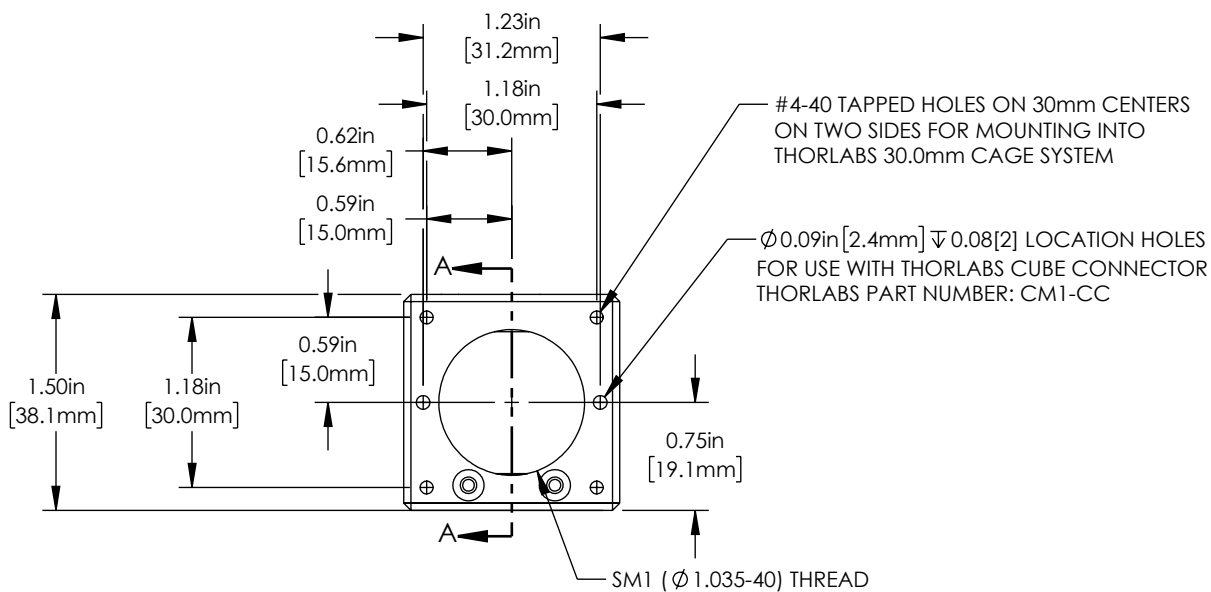
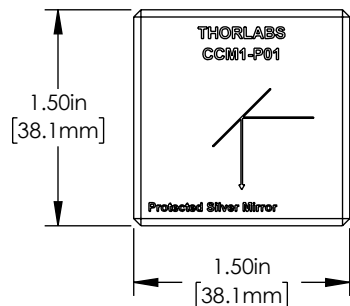
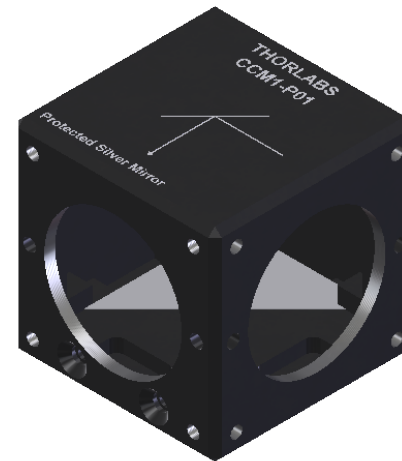

NOTES/SPECIFICATIONS:

1. OPTIC IS ALIGNED FOR REFLECTED BEAMS TO EXIT AT $90^\circ \pm 20$ arcmin

OPTICAL SPECIFICATIONS:

2. CLEAR APERTURE: $> \phi 17.5$ mm
3. SURFACE QUALITY: 40-20 SCRATCH-DIG
4. SURFACE FLATNESS: $< \lambda/10$ AT 633 nm
5. COATING: PROTECTED SILVER
 450 nm-2.0 μ m, Ravg: $>97\%$, 0° TO 45° AOI
 2.0 μ m-20.0 μ m, Ravg: $>95\%$, 0° TO 45° AOI

FOR INFORMATION ONLY
NOT FOR MANUFACTURING PURPOSES

DRAWING PROJECTION			THORLABS www.thorlabs.com	
NAME	DATE			
DRAWN	PK	25/JAN/21	30 mm CAGE MOUNTED PROTECTED SILVER RIGHT ANGLE MIRROR, 450 nm-20.0 μ m, #8-32 TAP	
APPROVAL	NI	18/NOV/22	MATERIAL	REV C
COPYRIGHT © 2022 BY THORLABS			SEE TABLE	
VALUES IN PARENTHESIS ARE CALCULATED AND MAY CONTAIN ROUND OFF ERRORS			ITEM # CCM1-P01	APPROX WEIGHT 0.085 kg