

INFORMATION ONLY, NOT FOR MANUFACTURING

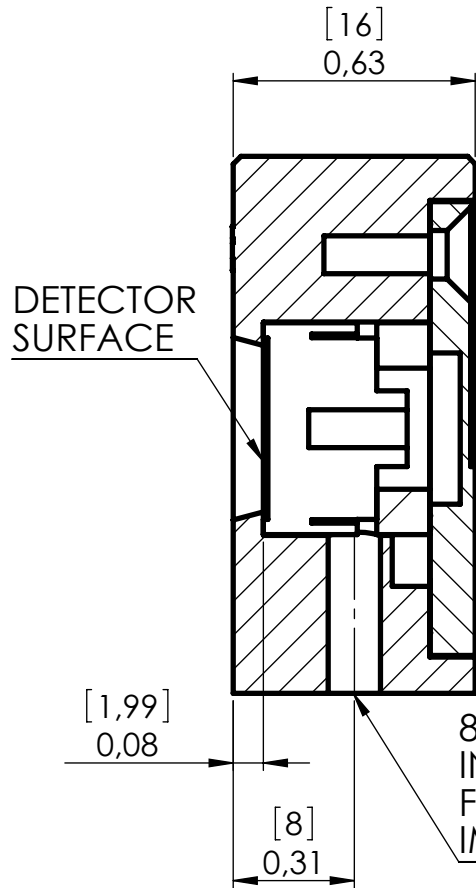

SECTION A-A

8-32 TAP  
INSULATION ADAPTERS  
FOR METRIC AND  
IMPERIAL POSTS INCLUDED

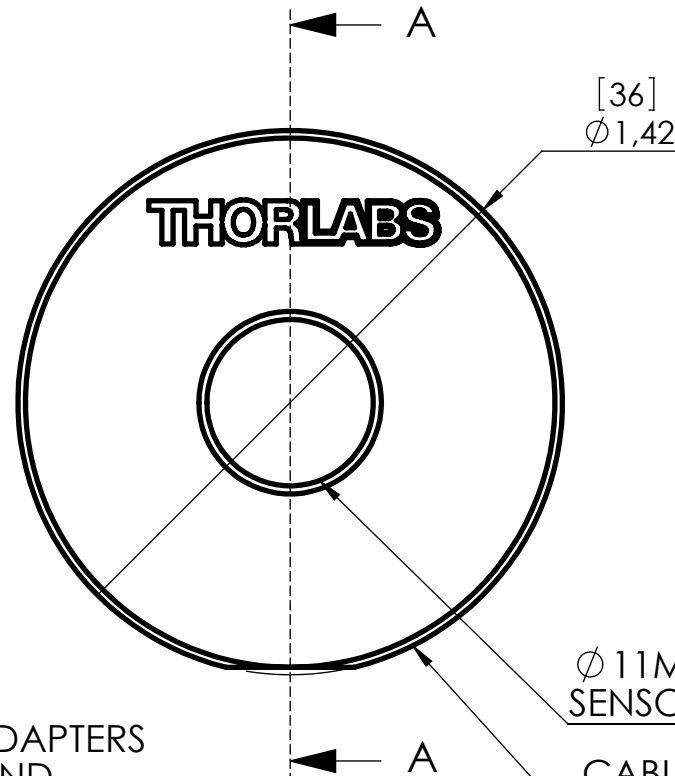

CABLE TO BNC CONNECTOR  
60" [1.5M] LENGTH

ALL DIMENSIONS IN PARANTHESES ARE MILLIMETERS

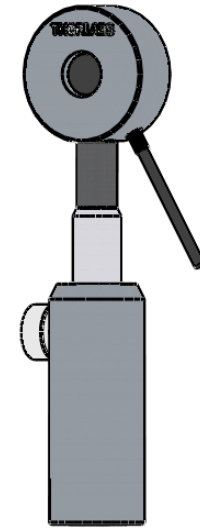

ASSEMBLY VIEW  
WITH INSULATION ADAPTER,  
POST AND POST-HOLDER

UNLESS OTHERWISE SPECIFIED:  
DIMENSIONS ARE IN INCHES  
TOLERANCES LINEAR:  $\pm 0,005$   
ANGULAR:  $\pm 30'$

DEBUR AND  
BREAK SHARP  
EDGES

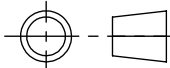

**THORLABS** Germany

	NAME	DATE
DRAWN	Go	08.09.2009
CHK'D	Go	08.09.2009
APPV'D	Go	08.09.2009

MATERIAL:  
N/A

TITLE:  
ENERGY SENSOR  
Ø 11mm ACTIVE AREA

NO PART OF THIS DRAWING MAY BE  
REPRODUCED OR TRANSMITTED IN ANY  
FORM OR BY ANY MEANS INCLUDING  
PHOTOCOPYING OR RECORDING  
WITHOUT THE PRIOR WRITTEN  
PERMISSION OF THORLABS GMBH

FINISH / TREATMENT:  
N/A

PART NO.  
ES111C

DWG NO. 18374-E01

REV A

SIZE A4