

ISOMETRIC VIEW  
SCALE 2:1

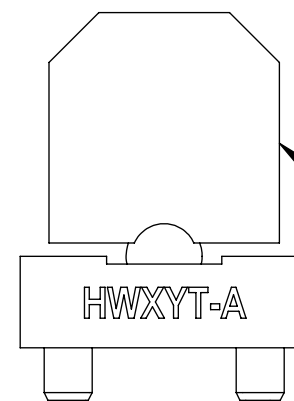
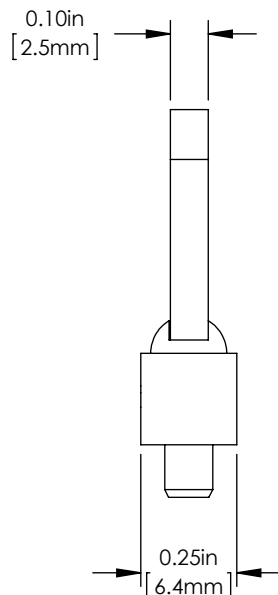
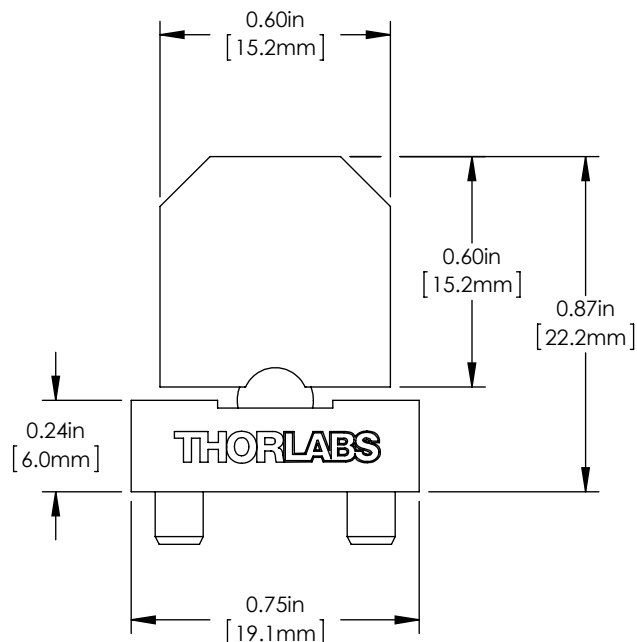

ADJUSTABLE PLATE FOR BEAM STEERING  
AR COATING RANGE - 350nm - 700nm

DOWEL PINS ON 1/2" CENTERS  
FOR MOUNTING INTO FIBERTABLE  
2 PLACES

TWEAKER PLATE NOTES/SPECIFICATIONS:

1. MATERIAL: UVFS PER MIL-G-174B  
Nd= 1.458+/-0.001 Vd= 67.821+/-1.0%  
PARALLELISM: ≤ 30 arcsec
2. THICKNESS TOLERANCE: +0.0 / - 0.2mm
3. SURFACE QUALITY: 40-20 SCRATCH-DIG
4. SURFACE FLATNESS: < λ/8 AT 632.8nm
5. CLEAR APERTURE: >90% OF AREA
6. COATING(S1 & S2): BBAR Ravg <0.5% FROM 350-700nm, 0° ±5° AOI

FOR INFORMATION ONLY  
NOT FOR MANUFACTURING PURPOSES

DRAWING PROJECTION				 www.thorlabs.com	
	NAME	DATE		FIBERBENCH TWEAKER MODULE AR COATING RANGE: 350nm-700nm	
DRAWN	HC	25/JUN/12		MATERIAL	
APPROVAL	JS	02/AUG/13		N/A	
COPYRIGHT © 2013 BY THORLABS					
VALUES IN PARENTHESIS ARE CALCULATED AND MAY CONTAIN ROUND OFF ERRORS				ITEM #	APPROX WEIGHT
				HWXYT-A	0.025 kg
				REV	C