

SM2 (Ø2.035-40) SERIES INTERNAL THREAD  
ACCEPTS Ø2.00in [Ø50.8mm] OPTICS  
(1) SM2RR RETAINING RING INCLUDED  
Ø1.90in [Ø48.5mm] CLEAR APERTURE

Ø0.24in [Ø6.1mm] THRU HOLE  
FOR USE WITH ER SERIES RODS  
4 PLACES

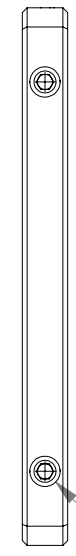

M4 LOCKING SETSCREW  
5/64in [2.0mm] HEX  
4 PLACES  
BOTH SIDES

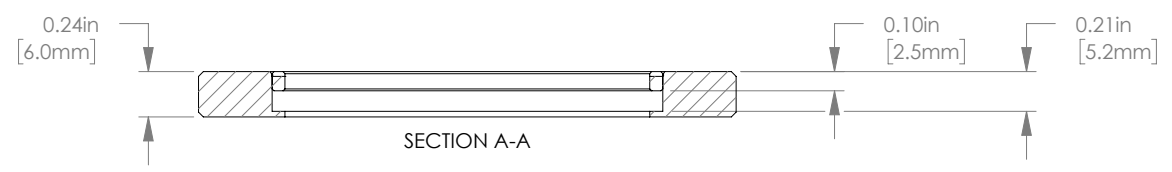

FOR INFORMATION ONLY  
NOT FOR MANUFACTURING PURPOSES

DRAWING PROJECTION		
NAME	DATE	
DRAWN	CG	15/AUG/18
APPROVAL	AK	15/AUG/18
COPYRIGHT © 2018 BY THORLABS		
VALUES IN PARENTHESIS ARE CALCULATED AND MAY CONTAIN ROUND OFF ERRORS		

<b>THORLABS</b> www.thorlabs.com		
60.0mm CAGE PLATE, 6.0mm THICK		
MATERIAL	N/A	REV A
ITEM #	LCP6S	APPROX WEIGHT 0.05 kg