

1:1 ISOMETRIC VIEW
FOR REFERENCE ONLY

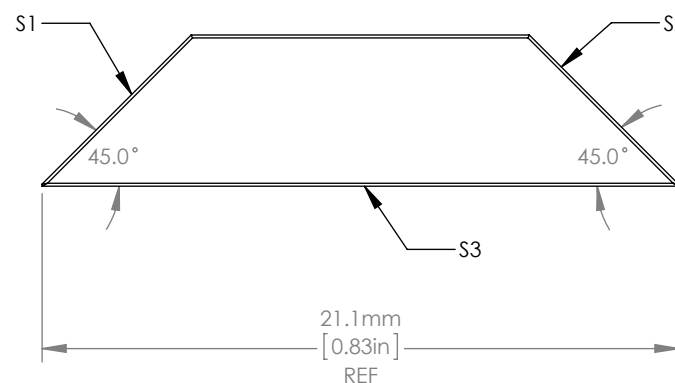
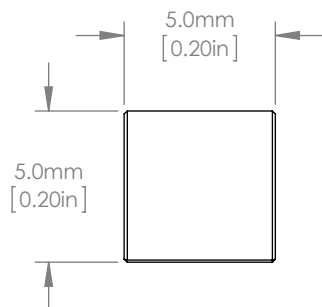

NOTES/SPECIFICATIONS:

1. CLEAR APERTURE: >70% OF MAX FACE WIDTH
2. SURFACE FLATNESS(S1,S2&S3): $\lambda/5$ @ 632.8nm
3. SURFACE QUALITY(S1,S2&S3): 40-20 SCRATCH DIG
4. ALL OTHER SURFACES: FINE GROUND
5. DIMENSIONAL TOLERANCE: $\pm 0.15\text{mm}$
6. ANGULAR TOLERANCE: $\pm 3\text{arcmins}$

FOR INFORMATION ONLY
NOT FOR MANUFACTURING PURPOSES

| | | | | |
|---|------|-----------|--|---------------|
| DRAWING PROJECTION | | | www.thorlabs.com | |
| | NAME | DATE | | |
| DRAWN | RJ | 08/SEP/12 | 5mm DOVE PRISM | |
| APPROVAL | DD | 08/SEP/12 | MATERIAL | REV |
| COPYRIGHT © 2011 BY THORLABS | | | N-BK7 | C |
| VALUES IN PARENTHESIS ARE CALCULATED AND MAY CONTAIN ROUND OFF ERRORS | | | ITEM # | APPROX WEIGHT |
| | | | PS990 | 0.05 kg |