

DO NOT SCALE

1/4-20 UNC MATRIX
CONTINUED OVER
WHOLE TOP FACE

4 X 1/4-20 UNC
MOUNTING HOLES

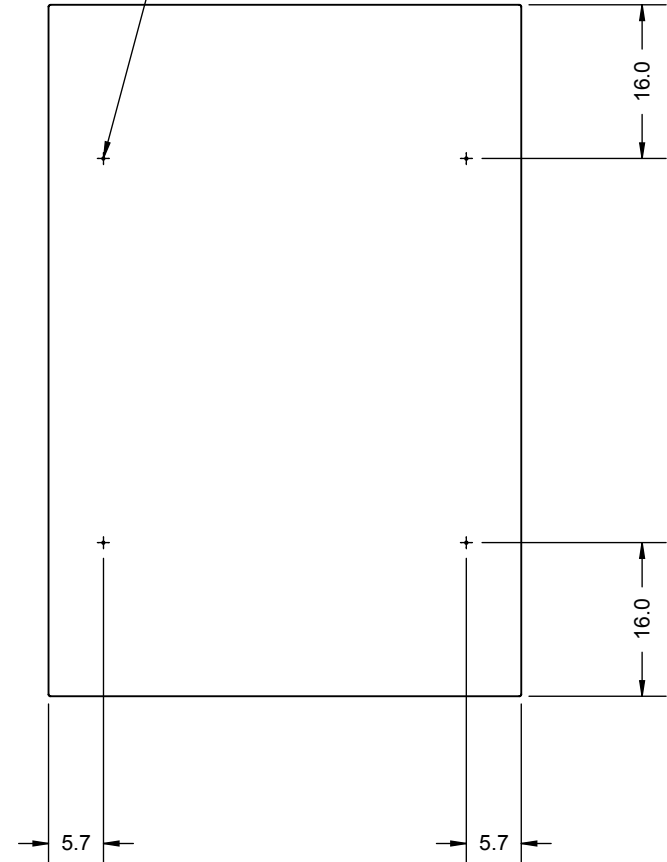
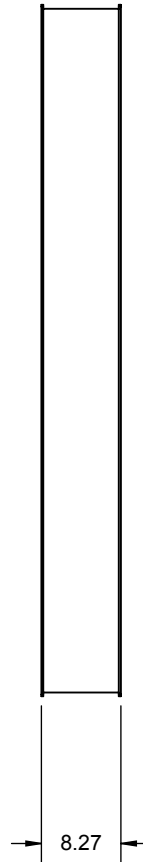
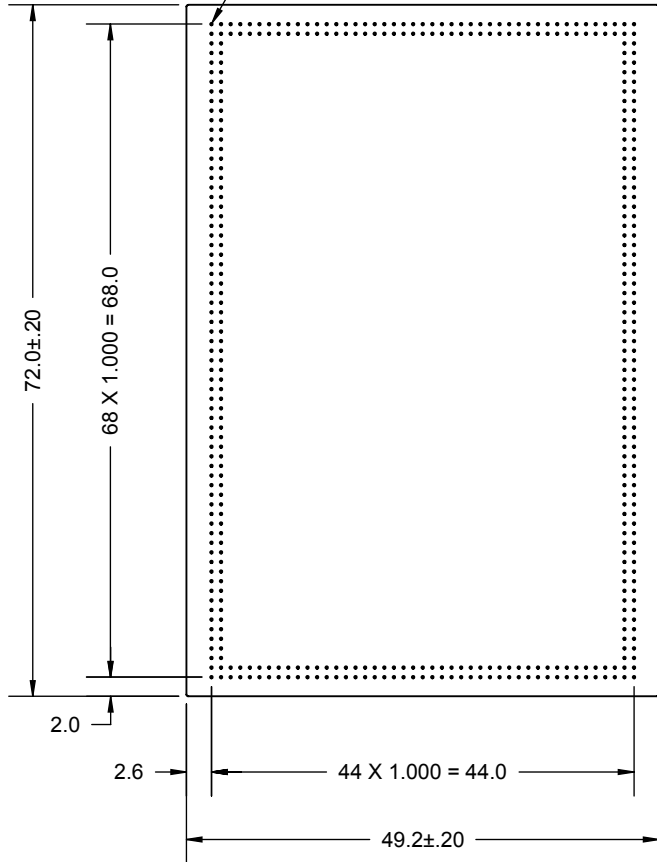

3	HOLES FOR PTS502/503 REMOVED	09.10.2009
2	TOLERANCES AMENDED	29.07.2009
1	ENGINEERING SUPPORT DRAWING	01.06.2006
ISSUE	C/N NUMBER	DATE
TOLERANCES X.X=±0.040, X.XX=±0.010, X.XXX=±0.004 ANGULAR=±0°30'		ALL DIMENSIONS IN INCHES
THIRD ANGLE PROJECTION DRAWN TO BS.308		

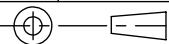

NOTES:

IF MOUNTING HOLES ARE REQUIRED FOR PTS502/PTS503 LEGS, PLEASE CONTACT OUR SALES DEPARTMENT

THORLABS		COPYRIGHT © THORLABS ALL RIGHTS RESERVED NO UNAUTHORISED DUPLICATION OR MANUFACTURE PERMITTED		
TITLE Ultra Series Optical Table - 6' x 4.1' x 8.3"				
DATE 09.10.2009	DWG PTR11108	SCALE 1:20		ISSUE 3
DRAWN <i>CIL</i>	APPD.	A4	SHEET 5 OF 13	