

ORDER OF ASSEMBLY		
ORDER	ITEM NUMBER	MATERIAL
①	ENGRAVED HOUSING	ALUMINUM
②	O-RING	NITRILE
③	473nm WAVEPLATE ASSY	CRYSTAL QUARTZ/SS
④	SM05RR	ALUMINUM

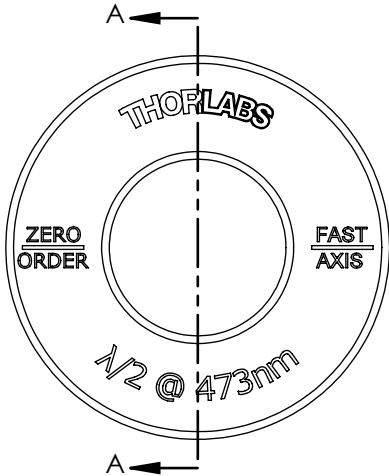
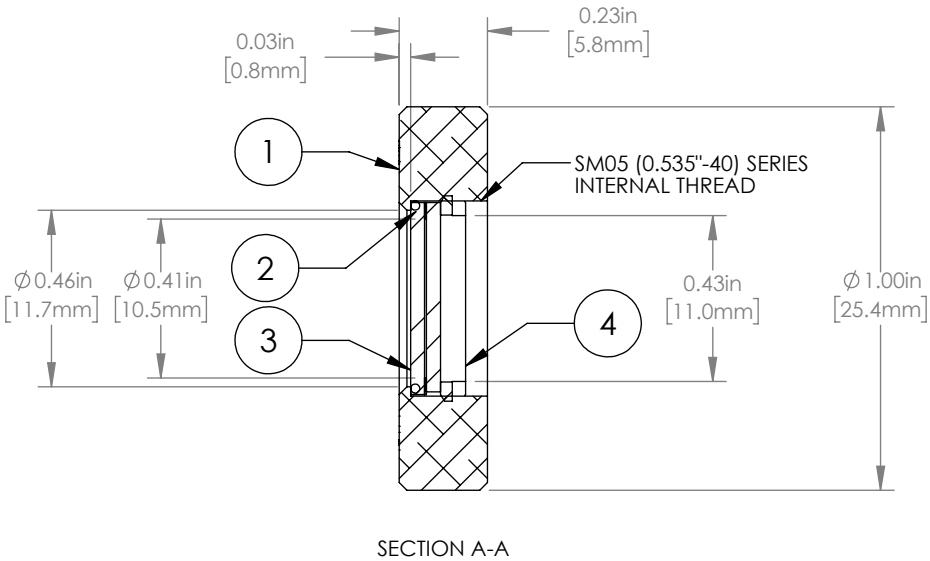

NOTES/SPECIFICATIONS:

- DESIGN WAVELENGTH: 473nm
- RETARDANCE: $\lambda/2$
- UNMOUNTED DIAMETER: 0.50" \pm 0.004 (12.7mm \pm 0.1)
- BEAM DEVIATION: <10 arcsec
- RETARDANCE ACCURACY (TYP): < $\lambda/300$
- TRANSMITTED WAVEFRONT ERROR: $\lambda/8$ (rms) AT 633nm
- SURFACE QUALITY: 20-10 SCRATCH-DIG
- CLEAR APERTURE: \varnothing 0.39" (\varnothing 10.0mm)
- COATING: VAR AT 473nm, R<0.25%, 0° AOI/PER SURFACE (4 TOTAL SURFACES)

FOR INFORMATION ONLY
NOT FOR MANUFACTURING PURPOSES

DRAWING PROJECTION			<div>THORLABS</div> <div>www.thorlabs.com</div>	
	NAME	DATE		
DRAWN	EMT	14/FEB/13	MOUNTED ZERO-ORDER HALF WAVEPLATE AT 473nm	
APPROVAL	DD	27/SEP/18	MATERIAL	REV B
COPYRIGHT © 2018 BY THORLABS			SEE TABLE	
VALUES IN PARENTHESIS ARE CALCULATED AND MAY CONTAIN ROUND OFF ERRORS			ITEM #	APPROX WEIGHT
			WPH05M-473	6 g